



Board of Public Works and Safety

Agenda Item

Cover Sheet

MEETING DATE: November 14, 2023

- ☐ Consent Agenda Item
- ☒ New Item for Discussion
- ☐ Previously Discussed Item
- ☐ Miscellaneous

ITEM #: 4

INITIATED BY: Amber Mink

- ☒ Information Attached
- ☐ Bring Paperwork from Previous Meeting
- ☐ Verbal
- ☐ No Paperwork at Time of Packets

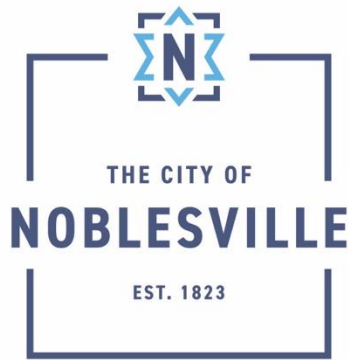

TO: Members of the Board of Public Works
FROM: Brandon Bennett, Parks & Recreation Director
SUBJECT: Purchase of portable shed-Skate Shak
DATE: November 14th, 2023

This ice-skating season brings us new opportunities and one of those is the procurement of a ice skating storage and sales facility. In the past we have used the Restrooms/maintenance area at Federal Hill, but that has since been removed for the Federal Hill Apartments.

This fall we looked at our options and tried to first use a temporary solution (an enclosed/heated tent) for the season until we could come up with a permanent solution. The tent company ended up not being able to have a rental available during this part of the season and if so it would have been close to \$15k for rental. We immediately pivoted and started working with a local Noblesville business Recreation Unlimited, to design a “shed.” They are the same vendor that built the Christmas Cottage for Federal Hill in 2016.

Once designed we used those specs to request two additional quotes from other shed builders in the state. We requested quotes from Rollin Mini Barns and also Yoder’s Portable Buildings. Neither company could meet the deadline for delivery nor the build out requests in the specs.

Recreation Unlimited was able to turn the building around in 7-10 days. The price of the building is \$32,933.53 and will be fully finished out and customized to our specs including electrical, heating/cooling, and countertops and concession windows.

The building will also be used in the parks during the other three seasons.

We recommend approval of the purchase of this portable “skate shak” From Recreation Unlimited for use at Federal Hill for skating season and in the parks during the rest of the year.

Recreation Unlimited, Inc.
15150 Herriman Blvd
Noblesville, IN 46060
(317)773-3545
www.recunlimited.com



INVOICE

INVOICE # 59162
DATE 10/24/2023
DUE DATE 11/23/2023

BILL TO
Brandon Bennett
701 Cicero Road
Noblesville, IN 46060
317162586

SHIP TO
Brandon Bennett
701 Cicero Road
Noblesville, IN 46060
3177162586

PLEASE DETACH TOP PORTION AND RETURN WITH YOUR PAYMENT.

SHIP DATE 01/01/3030	SHIP VIA delivery	CUSTOMER PHONE 3177162586	SALES REP INITIALS NS
--------------------------------	-----------------------------	-------------------------------------	---------------------------------

ITEM	DESCRIPTION	QTY	RATE	AMOUNT
Outdoor Structures:Shed	Shed Description:14'x20' Studio w/ 7' Sidewalls Exterior Finish: Board & Batten Exterior Color: White Trim Color: Burnished Slate Standard Metal Roof Color: Burnished Slate Door Type: Fiberglass Prehung & Plain Wood Doors Hinge Type: Continuous Piano Window Framing/Vent Color: white Standard Options: 60" Double Wood Doors	1	11,785.00	11,785.00T
Outdoor Structures:Shed Option	10" Extended Roof Overhang *\$2.41/sq ft	280	2.41	674.80T
Outdoor Structures:Shed Option	Board & Batten T1-11 Siding *+18% of unpainted shed base price	10,160	0.18	1,828.80T
Outdoor Structures:Shed Option	Standard Metal Roof Color: Burnished Slate *+12% unpainted shed base price	10,160	0.12	1,219.20T
Outdoor Structures:Shed Option	36" Fiberglass Prehung Door - Upgrade to Standard Door Height (6'8") Placement: Right Side (to the left of 6' transom)	1	770.00	770.00T
NOTE: Door Hinges should be located on the right side				

ITEM	DESCRIPTION	QTY	RATE	AMOUNT
Outdoor Structures:Shed Option	(Door swings open from left to right) CUSTOM DOOR HEIGHT: 8' Tall 60" Double Wood Doors *\$30 per 1 ft height increase per door	4	30.00	120.00T
Outdoor Structures:Shed Option	Placement: Back Side 5' Continuous Transom with Panes	1	174.00	174.00T
Outdoor Structures:Shed Option	Placement: Back Side - Above 8'x60" Double Wood Doors 6' Continuous Transom w/ Panes Placement: (1) centered on Right Side & (1) centered on Left Side	2	194.00	388.00T
Outdoor Structures:Shed Option	36"x36" Cut Out for Concession Windows Placement: (2) centered on Front Side	2	597.00	1,194.00T
Outdoor Structures:Shed Option	36" Wood Door "Shutters" - to Close 36" Concession Windows from the inside ***CUSTOM QUOTE FROM BUILDER**	2	300.00	600.00T
Outdoor Structures:Shed Option	Placement: Front Side (interior) Haley Poly Flooring *\$6/sq ft	280	6.00	1,680.00T
Outdoor Structures:Shed Option	20' Ridge Vent For Metal Roof (no pucks) *\$10/sq ft	20	10.00	200.00T
Outdoor Structures:Shed Option	Foam Spray Floor Insulation WITHOUT Metal Underbelly *\$10/sq ft *BR SPECIAL PRICING*	280	10.00	2,800.00T
Outdoor Structures:Shed Option	2'x3'6" Armadillo Composite Workbench (2) *CUSTOM QUOTE FROM BUILDER*	2	126.00	252.00T
Outdoor Structures:Shed Option	Color: Walnut Placement: Front Side Under Concession Windows 2'x5' Individual Awning **CUSTOM QUOTE FROM BUILDER**	2	330.00	660.00T
	Placement: Front Gable Side - Over 36" Concession Windows - Awnings will match the metal roof			
	The options below this line are needed for interior finishing of the shed:	1		0.00T
Outdoor Structures:Shed Option	Closed cell insulation (12.6 R Value/inch)	1	1,952.00	1,952.00T

ITEM	DESCRIPTION	QTY	RATE	AMOUNT
Outdoor Structures:Shed Option	Line interior- walls and ceiling	1	7,095.00	7,095.00T
Outdoor Structures:Shed Option	Electric panel box	1	397.00	397.00T
Outdoor Structures:Shed Option	Electric switches/ plugs	10	248.00	2,480.00T
Outdoor Structures:Shed Option	Overhead light strips (LED)	6	72.00	432.00T
Outdoor Structures:Shed Option	Heater/ AC unit	2	210.00	420.00T
				Subtotal: 37,121.80
Outdoor Structures:Shed Cash Discount 15%	Shed Cash Discount 15% Applies if the payment method is cash, check, credit, or debit card. This does not apply to purchases that are being financed.	-0.15	37,121.80	-5,568.27T
Outdoor Structures:Shed/Playhouse Delivery	16' Wide Local Shed Delivery to 46060 zip code Fence?:	1	745.00	745.00
Outdoor Structures:Shed/Playhouse Delivery	16' Wide Shed Delivery - Piolet Cars	2	275.00	550.00
Outdoor Structures:Shed/Playhouse Delivery	16' Wide Local Shed Delivery - Oversize Load Permit 10/19/23 CB: Removed sales tax from the estimate. Tax exempt form attached. 10/24/23 NS: BR approved Net 30 terms for purchase	1	85.00	85.00
SUBTOTAL				32,933.53
TAX (0)				0.00
TOTAL				32,933.53
BALANCE DUE				\$32,933.53

14'x20' Studio w/ 7' Sidewalls

Recreation
Unlimited

□ = 1'x1'
(i.e. 1' x 1' or 2' x 2')

Shed Diagram

BACK

RIGHT

LEFT

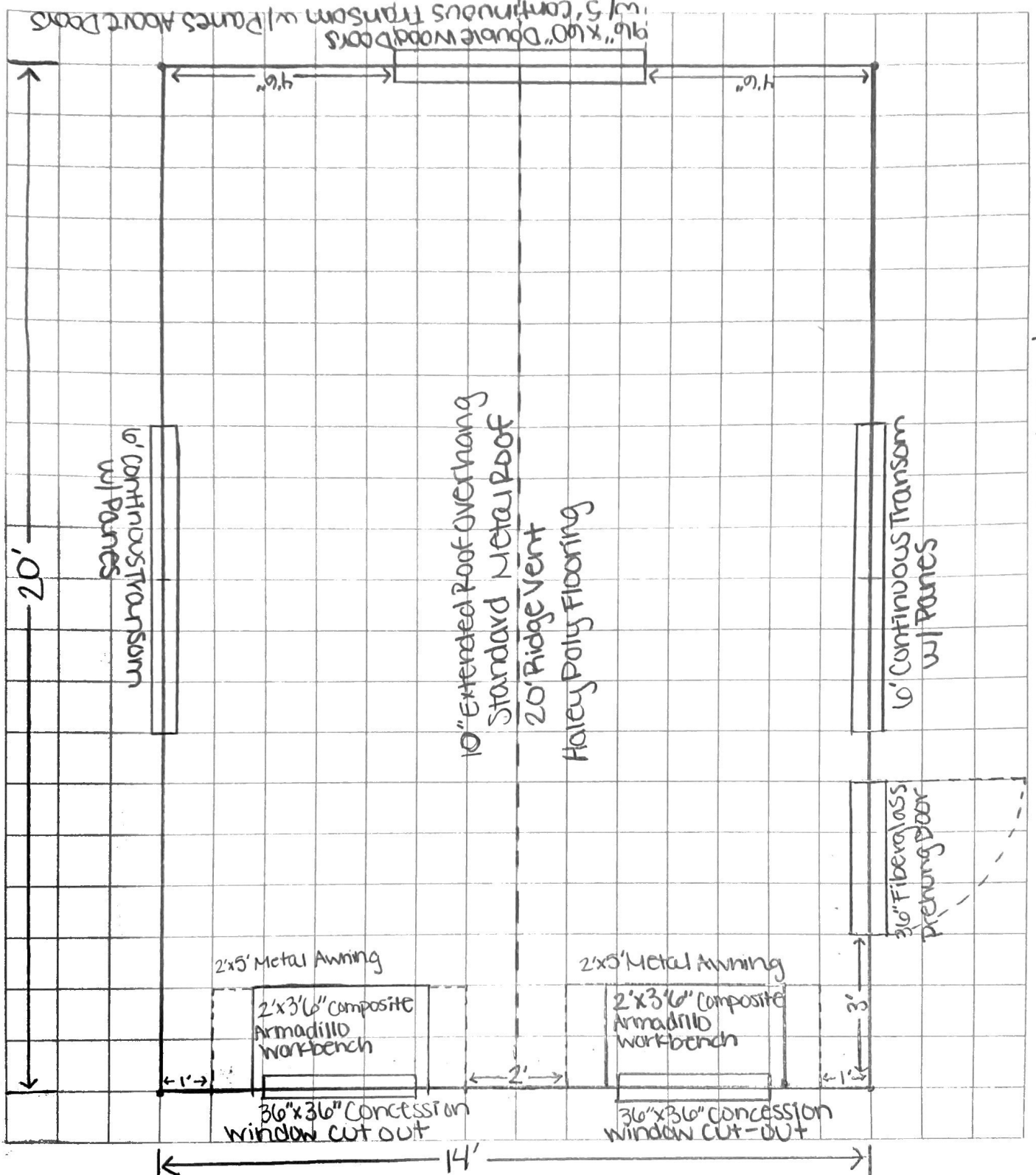

See reverse for building notes, if applicable

FRONT